



TRANQUILITY | 91.50m (300ft 2in) | Oceanco | 2014

The *original* Yachting Company  
*luxury experts since 1782*

SALE & PURCHASE | CHARTER | NEW BUILD | YACHT MANAGEMENT  
CREW PLACEMENT | INSURANCE | CHARTER MARKETING | MARINAS

No part of this material may be reproduced, stored in a retrieval system and marketed in any form and any media whatsoever without the prior written consent of the Central Agent. C&N trademarks are registered marks used under licence by CNI. The particulars are believed to be correct but their accuracy is not guaranteed and cannot be used for a contract. This yacht is offered subject to still being available.

Camper &  
Nicholsons  
International

YACHTING SINCE 1782

[www.camperandnicholsons.com](http://www.camperandnicholsons.com)  
[cni@camperandnicholsons.com](mailto:cni@camperandnicholsons.com)



## TRANQUILITY

Summer 2022 from: EUR 1,100,000 p/w  
Mediterranean (Eastern), Mediterranean (Western)

Winter 2021 from: USD 1,100,000 p/w

Caribbean Sea (Central), Caribbean Sea (Northern), Europe (Northern)

Length	91.50m (300ft 2in)	Gross tonnage	2998
Beam	14.50m (47ft 1in)	Cruising speed	14 Knots
Draft	4.09m (13ft 1in)	Guest	22
Builder	Oceanco	Cabins	11
Year	2014	Crews	Captain + 30

Video [https://www.youtube.com/watch?v=1-iOLI\\_V5io](https://www.youtube.com/watch?v=1-iOLI_V5io)



TRANQUILITY | 91.50m (300ft 2in) | Oceanco | 2014

## TRANQUILITY

Tranquility is an outstanding 91.5m superyacht built by the prestigious Oceanco shipyard in the Netherlands. Tranquility benefits from the finest aesthetics and technical standards and, testament to her pedigree, was awarded 'Yacht Of The Year Over 82m' at the 2014 World Superyacht Awards.

Built to Ice class and PYC compliant, Tranquility is truly exceptional in her capabilities. An ocean-crossing world explorer, this iconic superyacht boasts a vast 20sq.m swimming pool and accommodation for up to 22 guests.

Tranquility's interior was designed by Andrew Winch and along with Travertino Veluto marble and bleached oak with wenge finishing, the decor has a subtle, oriental influence. In the upper saloon, a fully operational, perspex-cased piano is a spectacular show piece, and there's a luxuriously comfortable lounge area as well as a formal dining room for 12.

Guest facilities include a spectacular aft beach club which transitions through to a fully-equipped gym boasting a large balcony on the starboard side allowing direct access to the sea, and an indulgent spa suite - complete with a sauna, Hammam, experiential showers, plunge pool and a massage/treatment room.

On Tranquility's aft upper deck, the large Jacuzzi pool takes centre stage and here there is an outdoor bar as well as plenty of free-standing sun loungers and deck furniture. Another Jacuzzi is found forward, with this area directly accessible from the master stateroom.

The master suite itself benefits from a private owner's study and an exceptionally large bathroom with a free-standing bathtub. The master suite's forward and elevated position delivers incredible views. The interior configuration allows for 9 further guest cabins, with the two VIP suites (located on the main deck) benefitting from private balconies, plus the Master Stateroom office able to convert to a double stateroom. In addition to this, Tranquility offers separate crew quarters for up to 29 ensuring an excellent crew to guest ratio for the highest standards of service.

The VIP stateroom located on the bridge deck is full beam and boasts a spectacular 180 degree panorama through floor to ceiling windows.

Tranquility achieves a top speed of 18 knots and comfortably cruises at 15 knots. Tranquility is fitted with zero speed stabilizers which increase on-board comfort when the yacht is at anchor.



### TRANQUILITY | 91.50m (300ft 2in) | Oceanco | 2014

---

## TRANQUILITY

### Main Features:

- World Superyacht Awards Winner
- Versatile accommodation for up to 22 guests
- 5,000nm Trans-Oceanic range
- Zero speed stabilisers
- Guest elevator
- Spectacular beach club
- Spa complete with sauna, Hamman and massage room
- Unique experiences such as the experiential shower and plunge pool
- Vast swimming pool on deck with jets
- Excellent crew to guest ratio
- Prestigious Andrew Winch Interior



C&N



TRANQUILITY | 91.50m (300ft 2in) | Oceanco | 2014

No part of this material may be reproduced, stored in a retrieval system and marketed in any form and any media whatsoever without the prior written consent of the Central Agent. C&N trademarks are registered marks used under licence by CNI. The particulars are believed to be correct but their accuracy is not guaranteed and cannot be used for a contract. This yacht is offered subject to still being available.

# TRANQUILITY

## Specifications:

### OVERVIEW

Name	TRANQUILITY
Yacht Type	Motor Yacht
Class	LR 100 A1 Passenger Yacht LMC UMS SCM EP ICE CLASS
Exterior Designer	Oceanco
Interior Designer	Winch Design

### ENGINES

Engines	2 MTU 3600 HP
Engine Model	20V 4000 M73L
Generators	Main: Three MTU 12V2000 M51 A 463 KW Hug soot filters: FSN20 400 Emergency generator: One 250 kW Volvo Penta type D9A2A-NG 1500, generating set producing 230v/400v AC/ 50 Hz/3-phase

### DIMENSIONS

Length Overall	91.50m (300ft 2in)
Beam	14.50m (47ft 1in)
Max Draft	4.09m (13ft 1in)
Builder	Oceanco
Gross Tonnage	2998

### MATERIALS

Hull	Steel
------	-------

### CONSTRUCTION

Builder	Oceanco
Year of Build	2014

### PERFORMANCE & CAPACITIES

Max Speed	20 Knots (approx)
Cruising Speed	14 Knots (approx)

### ACCOMMODATION

Guests	22
Cabins	11
Crew	Captain + 30

TRANQUILITY | 91.50m (300ft 2in) | Oceanco | 2014



TRANQUILITY | 91.50m (300ft 2in) | Oceanco | 2014

EXTERIOR

No part of this material may be reproduced, stored in a retrieval system and marketed in any form and any media whatsoever without the prior written consent of the Central Agent. C&N trademarks are registered marks used under licence by CNI. The particulars are believed to be correct but their accuracy is not guaranteed and cannot be used for a contract. This yacht is offered subject to still being available.



**TRANQUILITY** | 91.50m (300ft 2in) | Oceanco | 2014

EXTERIOR

No part of this material may be reproduced, stored in a retrieval system and marketed in any form and any media whatsoever without the prior written consent of the Central Agent. C&N trademarks are registered marks used under licence by CNI. The particulars are believed to be correct but their accuracy is not guaranteed and cannot be used for a contract. This yacht is offered subject to still being available.



C&N

TRANQUILITY | 91.50m (300ft 2in) | Oceanco | 2014

INTERIOR

No part of this material may be reproduced, stored in a retrieval system and marketed in any form and any media whatsoever without the prior written consent of the Central Agent. C&N trademarks are registered marks used under licence by CNI. The particulars are believed to be correct but their accuracy is not guaranteed and cannot be used for a contract. This yacht is offered subject to still being available.





TRANQUILITY | 91.50m (300ft 2in) | Oceanco | 2014

INTERIOR

No part of this material may be reproduced, stored in a retrieval system and marketed in any form and any media whatsoever without the prior written consent of the Central Agent. C&N trademarks are registered marks used under licence by CNI. The particulars are believed to be correct but their accuracy is not guaranteed and cannot be used for a contract. This yacht is offered subject to still being available.



C&N

TRANQUILITY | 91.50m (300ft 2in) | Oceanco | 2014

INTERIOR

No part of this material may be reproduced, stored in a retrieval system and marketed in any form and any media whatsoever without the prior written consent of the Central Agent. C&N trademarks are registered marks used under licence by CNI. The particulars are believed to be correct but their accuracy is not guaranteed and cannot be used for a contract. This yacht is offered subject to still being available.

---

## TRANQUILITY

### Special Features

**SPA**  
Sauna & Hammam

---

**GYM**  
With a starboard balcony allowing easy access to and from the water

---

**2 HELIPADS**  
Touch-and-go, on the main deck

---



**TRANQUILITY** | 91.50m (ft 2in) | Oceanco | 2014





C&N

TRANQUILITY | 91.50m (300ft 2in) | Oceanco | 2014

CABINS

No part of this material may be reproduced, stored in a retrieval system and marketed in any form and any media whatsoever without the prior written consent of the Central Agent. C&N trademarks are registered marks used under licence by CNI. The particulars are believed to be correct but their accuracy is not guaranteed and cannot be used for a contract. This yacht is offered subject to still being available.



TRANQUILITY | 91.50m (300ft 2in) | Oceanco | 2014

CABINS

No part of this material may be reproduced, stored in a retrieval system and marketed in any form and any media whatsoever without the prior written consent of the Central Agent. C&N trademarks are registered marks used under licence by CNI. The particulars are believed to be correct but their accuracy is not guaranteed and cannot be used for a contract. This yacht is offered subject to still being available.



C&N

TRANQUILITY | 91.50m (300ft 2in) | Oceanco | 2014

CABINS

No part of this material may be reproduced, stored in a retrieval system and marketed in any form and any media whatsoever without the prior written consent of the Central Agent. C&N trademarks are registered marks used under licence by CNI. The particulars are believed to be correct but their accuracy is not guaranteed and cannot be used for a contract. This yacht is offered subject to still being available.



TRANQUILITY | 91.50m (300ft 2in) | Oceanco | 2014

CABINS



C&N

TRANQUILITY | 91.50m (300ft 2in) | Oceanco | 2014

CABINS

No part of this material may be reproduced, stored in a retrieval system and marketed in any form and any media whatsoever without the prior written consent of the Central Agent. C&N trademarks are registered marks used under licence by CNI. The particulars are believed to be correct but their accuracy is not guaranteed and cannot be used for a contract. This yacht is offered subject to still being available.





C&N

TRANQUILITY | 91.50m (300ft 2in) | Oceanco | 2014

CABINS

No part of this material may be reproduced, stored in a retrieval system and marketed in any form and any media whatsoever without the prior written consent of the Central Agent. C&N trademarks are registered marks used under licence by CNI. The particulars are believed to be correct but their accuracy is not guaranteed and cannot be used for a contract. This yacht is offered subject to still being available.



TRANQUILITY | 91.50m (300ft 2in) | Oceanco | 2014

TECHNICAL ROOMS

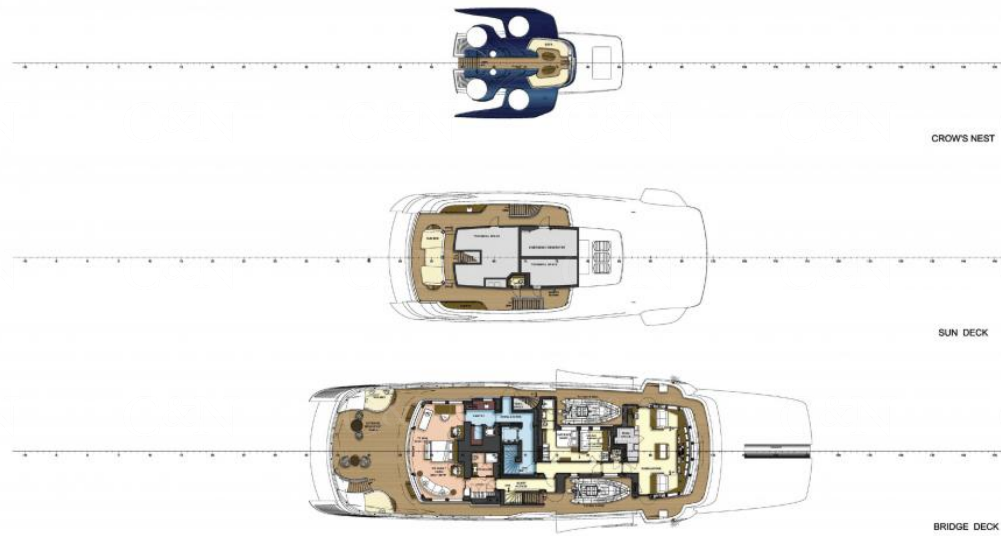

**TRANQUILITY** | 91.50m (300ft 2in) | Oceanco | 2014

GENERAL ARRANGEMENTS

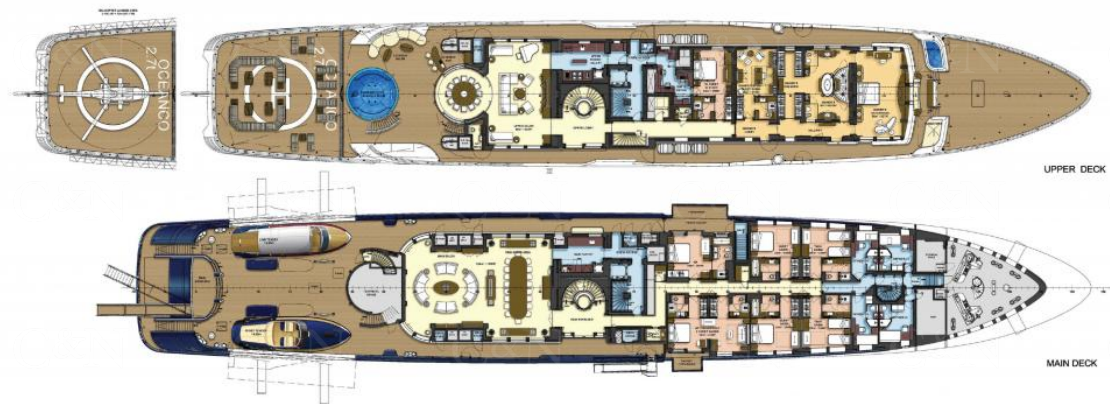

## TRANQUILITY | 91.50m (300ft 2in) | Oceanco | 2014

## GENERAL ARRANGEMENTS

No part of this material may be reproduced, stored in a retrieval system and marketed in any form and any media whatsoever without the prior written consent of the Central Agent. C&N trademarks are registered marks used under licence by CNI. The particulars are believed to be correct but their accuracy is not guaranteed and cannot be used for a contract. This yacht is offered subject to still being available.



## TRANQUILITY | 91.50m (300ft 2in) | Oceanco | 2014

## GENERAL ARRANGEMENTS

No part of this material may be reproduced, stored in a retrieval system and marketed in any form and any media whatsoever without the prior written consent of the Central Agent. C&N trademarks are registered marks used under licence by CNI. The particulars are believed to be correct but their accuracy is not guaranteed and cannot be used for a contract. This yacht is offered subject to still being available.